

LTECH

Bluetooth Smart LED Driver

ST-75-12-W1B / ST-75-12-W2B / ST-75-12-W3B

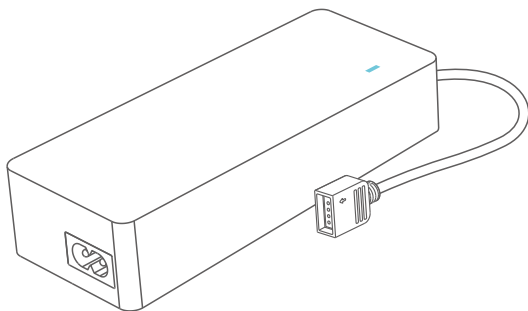

Manual

 Bluetooth®  RoHS

Product Introduction

Bluetooth smart LED driver adopts Bluetooth 5.0 SIG Mesh technology with low power consumption. You can easily control the smart LED driver with App on iOS or Android devices through Bluetooth connection. Via App, you can connect to your Bluetooth remotes and Bluetooth smart wireless switches to set the dim level, adjust color temperature and colors of lights. By working with the Super Panel 6S, you'll be able to achieve remote control, local scenes, cloud scenes and automation.

Product Features

- Bluetooth 5.0 SIG Mesh with high networking capability is reliable and stable.
- Controlled by a Bluetooth panel, Bluetooth remote and a mobile phone.
- Achieve the output consistency of dynamic lighting effects.
- 0-100% dimming range, down to 0.1%.
- 0-100% flicker-free dimming with high frequency exemption level.
- With active PFC function.
- 100-240Vac wide voltage input.
- Overheat, overvoltage, overload and short circuit protection and automatic recovery.
- Class 2 driver with full protective plastic housing that complies with safety extra-low voltage standard.
- Suitable for indoor light applications of I / II / III type.

Package Contents



Driver ×1



LED strip connector ×1



Power cord ×1



Manual ×1

Product Size

Unit: mm



Product Parameters

Model		ST-75-12-W1B	ST-75-12-W2B	ST-75-12-W3B
OUTPUT	Control Mode	DIM	CT	RGB
	Output Voltage	12Vdc		
	Output Current	5A	2.5A×2CH	1.67A×3CH
	Output Power	Max. 60W		
	Strobe Level	High frequency exemption level		
	Dimming Range	0-100%, down to 0.1%		
	Overload Power Limitation	≥102%		
	Low Frequency Ripple	≤200mV		
INPUT	Wireless Type	Bluetooth 5.0 SIG Mesh		
	Input Voltage	100-240Vac		
	Frequency	50/60Hz		
	Input Current	Max. 0.77A		
	Power Factor	PF>0.99/115Vac / PF>0.95/230Vac, at full load		
	THD	115Vac@THD≤9% / 230Vac@THD≤17%		
	Efficiency(typ.)	91%		
	Inrush Current(typ.)	Cold start 40A at 230Vac		
	Anti Surge	L-N: 1KV		
	Leakage Current	Max. 0.5mA		
ENVIRONMENT	Working Humidity	20 - 95%RH, non-condensing		
	Storage Temp., Humidity	-40°C - 80°C, 10-95%RH		
	Vibration	10-500Hz, 2G 12min./1cycle, 72 min for X, Y and Z axes respectively		
PROTECTION	Overheat Protection	Intelligently adjust or turn off the output current if the PCB temperature ≥ 110°C, auto recovers		
	Overvoltage Protection	Shut down the output when non-load voltage ≥ 13V, auto recovers		
	Overload Protection	Shut down the output when power load ≥ 102%, auto recovers		
	Short Circuit Protection	Enter hiccup mode if short circuit occurs, auto recovers		
SAFETY & EMC	Withstand Voltage	I/P-O/P: 3750Vac		
	Isolation Resistance	I/P-O/P: 100MΩ/500VDC/25°C/70%RH		
	Safety Standards	IEC/EN61347-1, IEC/EN61347-2-13		
	EMC Emission	EN55015, EN61000-3-2 Class C, IEC61000-3-3		
	EMC Immunity	EN61000-4-2,3,4,5,6,8,11 EN61547		
	Strobe Test Standard	IEEE 1789		
OTHERS	Dimensions	L143×W58×H32(mm)		
	Package Size	L168×W123×H35(mm)		
	Weight(G.W.)	430g		

System Diagram

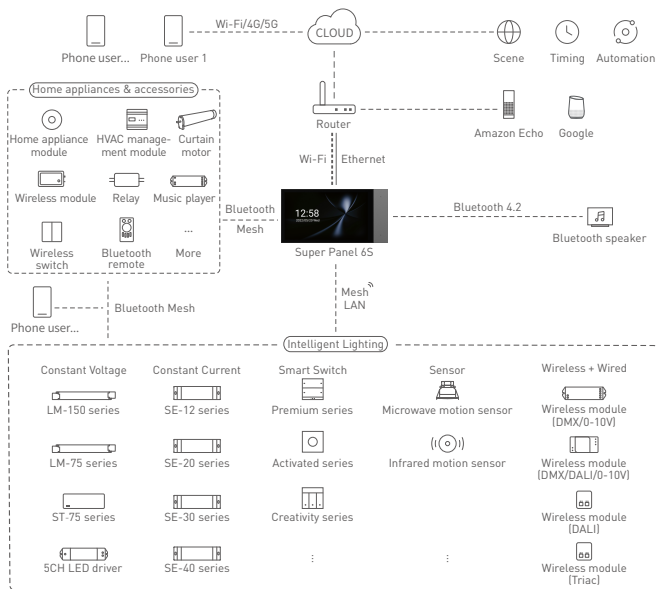

Recommended Applications

1. Achieve fast dimming control.

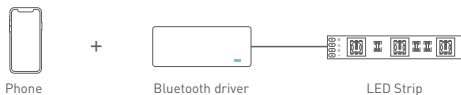

2. The App, remote and intelligent wireless switch can control the driver after the remote is set to connect Bluetooth signal with the App.



3. Both App and Super Panel can control the driver simultaneously after the Super Panel 6S is set to connect Bluetooth signal with the App. By connecting the Super Panel 6S to a network, you are allowed to control the driver, and achieve local scenes, cloud scenes and automation remotely with the App.



4.More applications of intelligent control are waiting for you to set up.

How to Install

Please use 22 gauge electrical wire to connect.

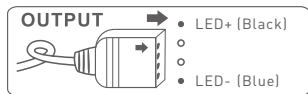
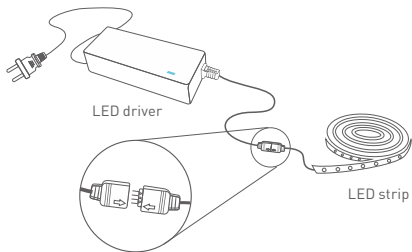

ST-75-12-W1B

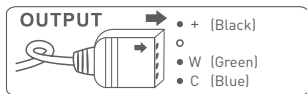

ST-75-12-W2B

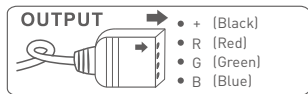

ST-75-12-W3B

App Operating Instructions

1. Register an account

Scan the QR code below with you mobile phone and follow the prompts to complete the App installation. Open the App and log in or register an account.



2. Paring instructions

Create a home if you are a new App user. Click “+” icon in the upper right corner of “Room” interface to access “Add device” list. Pick 【Smart light】 and follow the on-screen prompts to add the device.

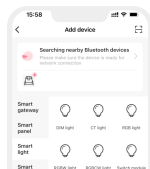
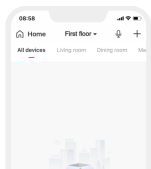

3. Control interface settings

After pairing up your device, go to the control interface. You'll be able to achieve your desired lighting effects by setting the dim level, adjusting color temperature and colors of lights. Click “Theme” and you'll easily switch to multiple theme lighting effects with one tap. Click “Mode” and the App provides you editable normal modes and editable advanced modes. Customize dynamic modes to put you into a more colorful life.

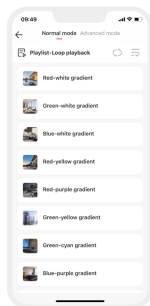
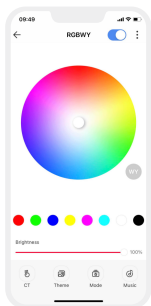

4. Light groups

Users are able to combine the same type of light fixtures into a group to control them simultaneously. Once you create the group, you can set the dim level or change color temperature and colors more easily. Switch to “Group” menu and click “+” icon in the upper right corner. Follow the prompts to rename the group and click “Next” to pick the lights you are going to group together and to save them.

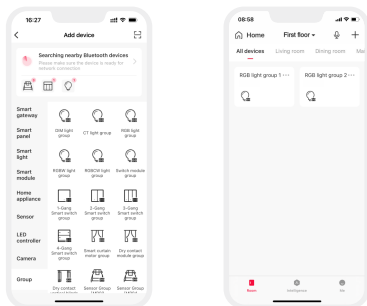

5. Advanced functions

This smart driver can be linked up with gateway devices such as Super Panel 6S to achieve the advanced functions from local scenes and cloud scenes to automation.

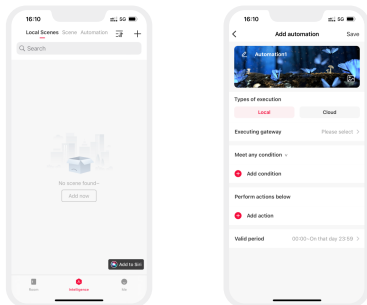

How to Reset to Factory Defaults

Method 1 (Recommended): Go to the App settings and click "Delete Device". When the lamp flashes 5 times, the device will exit the network successfully.

Method 2: Make sure the driver is well-connected to a lamp and the lamp is on, turn it off with the switch and after 15s turn it on. After 2s, turn it off again. Repeat the same operation 6 times. When the lamp flashes 5 times, reset the device to factory defaults successfully.

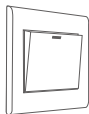

Turn it on 2s
↑
Turn it off 15s

Under the driver being power-on

Turn it off — 15s — Turn it on — 2s —
(Repeat 6 times)

FAQs

1. What should I do if I fail to add the device?

- Please make sure the device is powered on normally and is in the activated mode.
- Please make sure the device hasn't been added by any other account. If it did, please reset to factory defaults manually.
- The recommended distance between the mobile phone and the device is no more than 20 meters.
- If the device has been forced to delete, please reset to factory defaults manually and then add the device again.

2. What should I do if the device disconnects from the network?

- Please make sure the device is powered on normally.
- Please make sure the router works normally and the network runs smoothly.
- If you control the device remotely, please make sure your phone network runs smoothly.

3. How to control remotely and set cloud scenes?

- Remote control and cloud scenes can be achieved only by working with LTECH Super Panel.

4. How to share control of your home devices?

- Please go to "Me" - "Home Management" and access the home you want to share. Click "Add Member" and follow the prompts to add members to your home.

* This manual is subject to changes without further notice. Product functions depend on the goods. Please feel free to contact our official distributors if you have any question.

Attentions

- This product must be installed and adjusted by a qualified professional.
- This product is non-waterproof (special models excepted). Please avoid the sun and rain. When installed outdoors, please ensure it is mounted in a water proof enclosure.
- Good heat dissipation will extend the life the product. Please install the product in a environment with good ventilation.
- When you install this product, please avoid being near a large area of metal objects or stacking them to prevent signal interference.
- Please keep the product away from a intense magnetic field, a high pressure area or a place where lightning is easy to occur.
- Please check whether the working voltage used complies with the parameter requirements of the product.
- Before you power on the product, please make sure all the wiring is correct in case of incorrect connection that may cause a short circuit and damage the components, or trigger a accident.
- If a fault occurs, please do not attempt to fix the product by yourself. If you have any question, please contact the supplier.

Warranty Agreement

- Warranty periods from the date of delivery: 5 years.
- Free repair or replacement services for quality problems are provided within warranty periods.

Warranty exclusions below:

- Beyond warranty periods.
 - Any artificial damage caused by high voltage, overload, or improper operations.
 - Products with severe physical damage.
 - Damage caused by natural disasters and force majeure.
 - Warranty labels and barcodes have been damaged.
 - No any contract signed by LTECH.
1. Repair or replacement provided is the only remedy for customers. LTECH is not liable for any incidental or consequential damage unless it is within the law.
 2. LTECH has the right to amend or adjust the terms of this warranty, and release in written form shall prevail.



www.ltech-led.com

ZHUHAI LTECH TECHNOLOGY CO., LTD.

15th Building, No.3, Pingdong 6th Road, Nanping
Technical Industrial Park, Zhuhai, Guangdong, China